

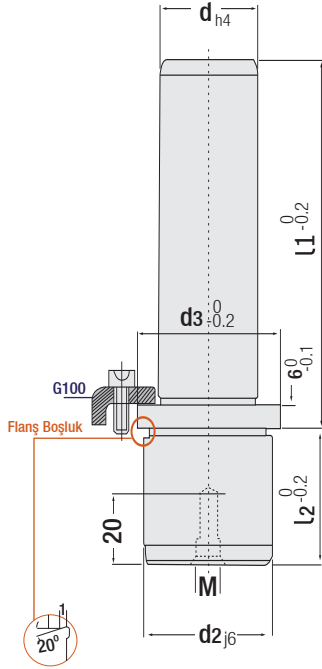

Code: G15

Guide Pillar, Thickbacked



**Flange Fitting:** It is perpendicular angle locating on to die plate surface.

Compatible Bushes

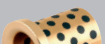

G41 - 42 - 43



G 40 - 44



G 35 - 36



G 33 - 34

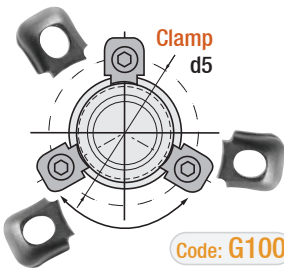

Code: G100

G15 / Guide Pillar, Thickbacked

It is used as guiding component at dies and blow moulds.

Advantageous Product:

Pillar mounting diameter and bush mounting diameter have the same tolerance value. In machining of guide pillar / bush holes on dies with the advantage of using same cutting tool (drill / reamer) for both guide pillar & bushes hole. Thus, the necessity of using different cutting tools will disappear.

Code: G15

Ø d	l1	d2	d3	l2	Pabuç d5	M
20	100	28	34	23	46.2	M8
	125					
	140					
	160					
	180					
25	100	34	39	30	51.4	M8
	125					
	140					
	160					
	180					
30	200	39	44	37	56.6	M8
	220					
	240					
	260					
	280					
	300					
	320					
	340					
	360					
	380					

GTH guide pillars are polished with surface polishing machine at final stage of production (after grinding).

Material: 1.1213 (Cf53)  
Hardness: 58 - 62 HRC

Operating Components: G100 - G33  
G34 - G35 - G36 - G40 - G42

Order: G15. d x l1

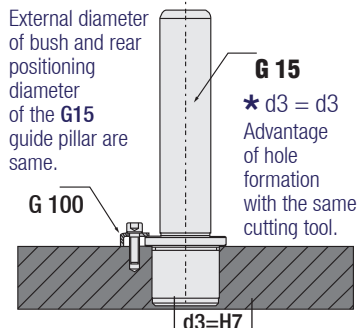
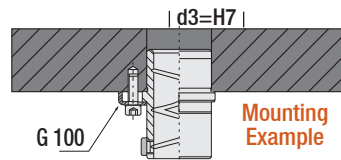

Code: G110

Mounting Flange

Guide pillar fixation & Support washer

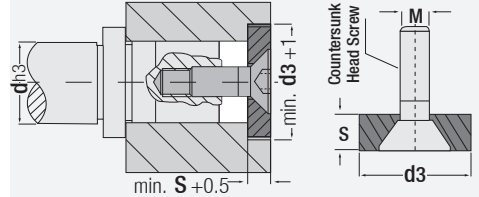

\* Reliable product used for guide pillar with centre collar mountings min. d3 + 1

\* It can also be used to support for ejector plates in injection moulds / etc.

Ø d3	Pillar Diameter d	Flange S	Screw M	
22	Ø 15 / 16	5.5 mm	M8 x 20	
25	Ø 19 / 20			
32	Ø 24 / 25			
40	Ø 32 / 30	7.5		
50	Ø 38 / 40	9.5 mm		
60	Ø 48 / 50			
73	Ø 60 / 63			
93	Ø 80	12		M12 x 20

Order: G110. d3

Usage: Guide pillar fixation (Die)  
Support washer (Mould)

Mounting Dimensions and Tolerances of Demountable Die Guide Pillars

Technical Info

Dimensions Given: Recommended (suggestion) for product: G10 Guide pillar.

Mounting System: Soft tight fitting system has been selected and determined for G10 Guide pillar.

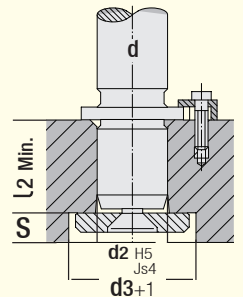

"d" Guide Pillar Dia.	d2 H5	d3 +1	l2	S
15 / 16	+0.008	22	14.5	5.5
19 / 20	+0.009	25	17.5	5.5
24 / 25	+0.009	32	24.5	5.5
30 / 32	+0.011	40	29.5	7.5
38 / 40	+0.011	50	27.5	9.5
48 / 50	+0.013	60	37.5	9.5
60 / 63	+0.013	80	37.5	9.5
80	+0.013	95	48	12